

## 36 inch Bottom Mount Built-in Refrigerator Panel Ready with ice maker & internal water dispenser Heritage Series

\$ 6,199



### REF36BMBZPNV

This Bertazzoni 36" built-in refrigerator & freezer is engineered and manufactured to meet the highest grade of quality and performance. Using one of the 3 available handle kits in Professional, Master Series and Heritage Series style, it integrates seamlessly with all other Bertazzoni appliances into style-harmonized suites for a true, high-performing kitchen.

This entire unit has ample storage capacity, with 14.3 cubic feet of refrigerator volume and 5.5 cubic feet of freezer space. The refrigerator compartment has 3 shelves of which 2 are height-adjustable and 2 full extension crispers. Additionally, it features 1 Fresco drawer with separate digital controls. This zone precisely keeps the temperature just above 32 F, preserving fresh food nutrients, flavors, and visual appearance substantially longer. The Dual Cooling Shield System provides an automatic defrosting function for both evaporators to ensure optimized food storage conditions. The freezer compartment has 2 metal drawers and an automatic ice maker.

The electronic touch-control LED interface simplifies setting and monitoring of all vital functions. LED lights on the top and sidewall provide clear illumination of the interior space. The internal water dispenser is equipped with an inline filter for hygienically clean drinking water and ice. Replacement water filters are available for purchase [here](#).

The EnergyStar qualification of this model ensures a highly reduced energy consumption, while providing optimal performance ratings.

Using one of the 3 available handle kits in Professional, Master and Heritage Series style, this refrigerator integrates seamlessly with all other Bertazzoni appliances into style-harmonized suites for a true, high-performing kitchen.

[Handle kits are sold separately.](#)

All Bertazzoni appliances are covered by a 2-year warranty.

[Guarda online](#)

# Specifications

## Features

### General features

Size	36 in
Cooling system	frost free
User interface	LED touch control interface
Display functions	Super Cool, Super Freeze, Ice maker, Water filter replacement reminder, Internal water dispenser, Eco Mode, Vacation Mode, Sabbath Mode
Lighting	LED side & top rail illumination
Door ajar alarm	yes
Door finishing	panel ready
Doors reversibility	field reversible door hinges
Cabinet finishing	stainless steel back wall
Refrigerator net capacity	14.3 cu.ft <sup>3</sup>
Refrigerator shelves	2 height-adjustable + 1 stationary
Refrigerator drawers	1 + 1 Fresco drawer with separate temperature control
Door storage	3 bins
Freezer net capacity	5.5 cu.ft <sup>3</sup>
Freezer drawers	2 full extension drawers
Automatic ice maker	yes
Ice production capacity	3.9 lbs / 24 hrs
Water filter	yes
Water supply pressure	25-80 PSI
Sound rating	43 dbA
Certification	ADA Compliant, CEC, ETL
DOE compliant	yes

### Technical specifications

Electrical supply	115 V - 60 Hz - 2.5 A
Power rating	120 W
Power connection	NEMA 5-15P with 90" power cord
Energy consumption	590.0 kwh/yr

---

# Dimensions

---

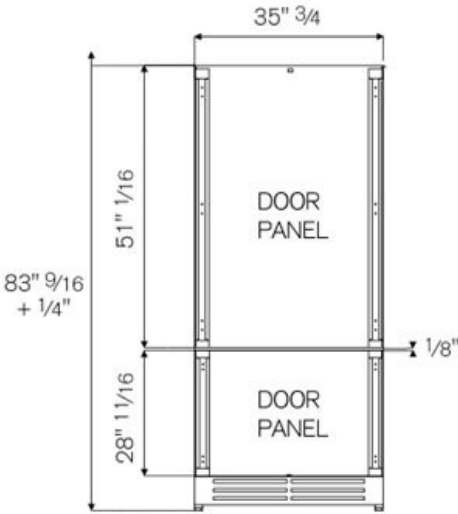
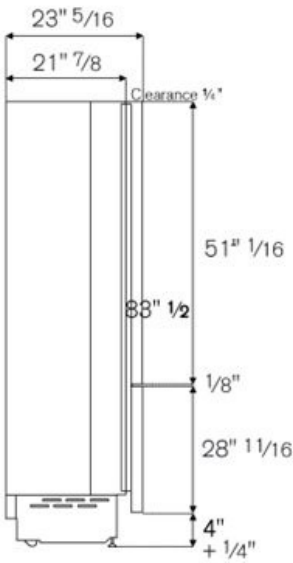

+1/4" for the adjustable max height of the leveling feet